

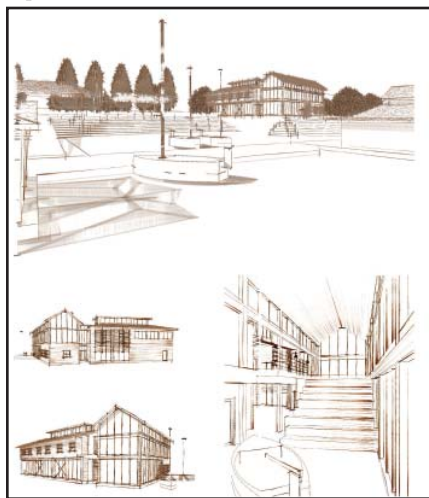

Seattle's plan for Lake Union Park includes expanded CWB facilities and access.



Funding To-Date

Capacity Building

- M. J. Murdock Trust \$150,000
- Paul G. Allen Foundation \$150,000
- Russell Grinnell Trust \$80,000

Planning

- Transportation Enhancement \$250,000
- Institute of Museum and Library Services \$144,000

Facilities

- (need \$6 million for total project)**
- Seattle Parks Foundation \$400,000
- King County 4Culture \$90,000
- Wash. State Heritage Capital \$235,000
- Tourism Cares 10,000
- Individual donors \$300,000

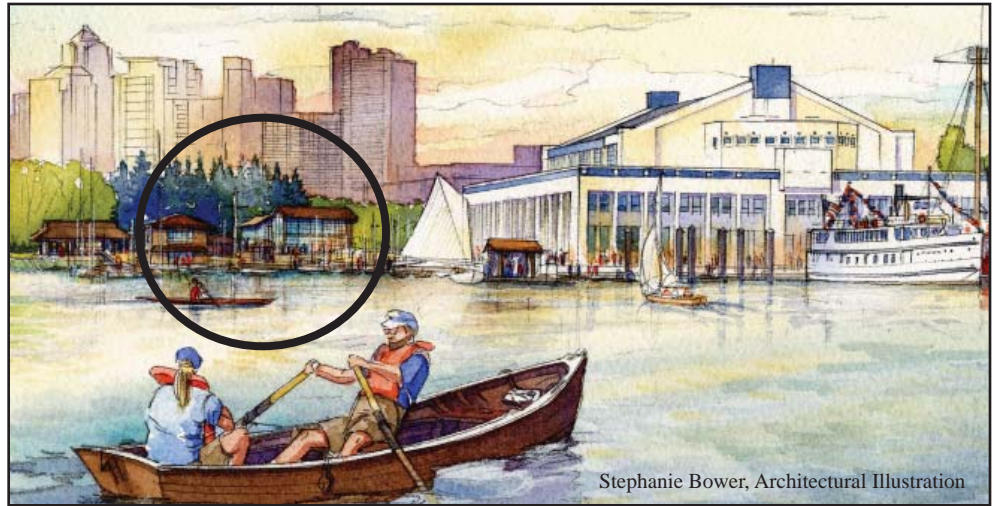

Stephanie Bower, Architectural Illustration

**The Center for Wooden Boats Education Center
Seattle, Washington**

The Center for Wooden Boats (CWB) is working with the City of Seattle, the Washington State Department of Natural Resources and the local community to greatly expand a civic resource that will increase public access to boating and maritime heritage in the heart of Seattle.

The Center for Wooden Boats requests a FY 2009 appropriation of \$2,000,000 to complete environmental improvements, expand public access to the water, and build new education facilities.

This project will:

- Develop a new 10,000 sq ft building in Lake Union Park to create a classroom for youth programs and field trips, a multipurpose space for lifelong learning programs and community meetings, a museum boatshop to preserve traditional maritime craft and skills, and a hub from which to plan and manage year-round public maritime heritage programs at Lake Union.
- Improve the environmental conditions of the waterway that is occupied by CWB's current facilities, by removing toxic pilings, increasing water circulation, increasing light penetration through the docks, and enhancing the shoreline to promote fish and wildlife habitat.
- Create a unique urban walkway along the water's edge by rehabilitating CWB's current entrance and selected floats. Build a new entrance connecting CWB's facilities in Waterway Four to Lake Union Park to create greater public access to the waterfront.

Community Support

- Seattle Parks and Recreation and Seattle Parks Foundation.
- South Lake Union Urban Center Neighborhood Plan 2007.
- Plan for Lake Union Park, adopted by Seattle City Council 2007.
- Seattle/King County Task Force on Maritime Heritage Report 2005.

Recent Recognition of CWB

- South Lake Union Chamber of Commerce. "Non-profit of the Year" 2008.
- King County inaugural Heritage Tourism Award 2007.
- Museum Small Craft Association Lifetime Achievement Award 2007.
- Outstanding Heritage Event, Assoc. of King County Historical Orgs. 2007.

**Contact: Betsy Davis, Executive Director 206-382-2628 betsy@cwbo.org
1010 Valley Street, Seattle WA 98109 www.cwbo.org**